

DO NOT SCALE

- Notes**
- All levels are in metres to Ordnance Datum (m AOD).
 - The contractor is to check all dimensions and levels and report any discrepancies or omissions to the engineer.
 - All works and materials to be in accordance with:
 - North Yorkshire County Council Specification for Highways
 - Final and final dimensions to be in accordance with BCP specification.
 - Notes and changes shall be laid to line and level and not to be scaled until inspected and approved by the Engineer.
 - All dimensions are in millimetres unless otherwise noted.
 - For outcrop areas refer to architects specification & details.
 - For building set out see architects plan.
 - Existing services within areas of work are to be investigated and detailed (except where required).
 - Contractor is to arrange inspection of proposed highway during works, any inspection completed are to be reported back to engineer and approved on site.

- Legend**
- Proposed Levels
 - Existing Levels
 - H&D 150mm x 225 Half Battlement
 - PK 50 x 150mm Pin-Kee Edging
 - OK Centre kerb 225mm chamfer
 - DK Drop kerb
 - CB Channel Block laid flush
 - Proposed Highway Construction
 - Proposed Footpath Construction
 - Proposed Block Paving
 - Proposed Gravelstone
 - Proposed Permeable Paving
 - Proposed Retaining Wall
 - Proposed Flag on Edge
 - Proposed Gravel Board

REVISED PLAN

THIS PLAN HAS BEEN REVISED BY THE ARCHITECT OR ENGINEER AND THE CONTRACTOR IS TO CHECK ALL DIMENSIONS AND LEVELS AND REPORT ANY DISCREPANCIES OR OMISSIONS TO THE ENGINEER AND APPROVED ON SITE.

Issued for	By	Rev	Date
Landscape plan	TG	04	07/05/18
Driveway plan	TG	03	03/04/18
Revised garden gradients	TG	03	03/04/18
Issued as Information	RL	01	12/12/17

Client
Lindum Group

Project
Rainbow Lane
Malton
North Yorkshire

Drawing Title
Proposed External Works Plan
Sheet 2 of 3

Drawn	RL	Date	07/12/17
Checked	SR	Date	07/12/17
Scale	1:200	Original Size	A1

billingham george & partners
CIVIL & STRUCTURAL ENGINEERS
14 Floor, Wellington House, Wellington Court,
Goodwood Park, Leeds, LS10 2TA
t 0113 276 0000 e info@billingham.co.uk
www.billingham.co.uk

Dwg No: 151672-101 Rev: P4

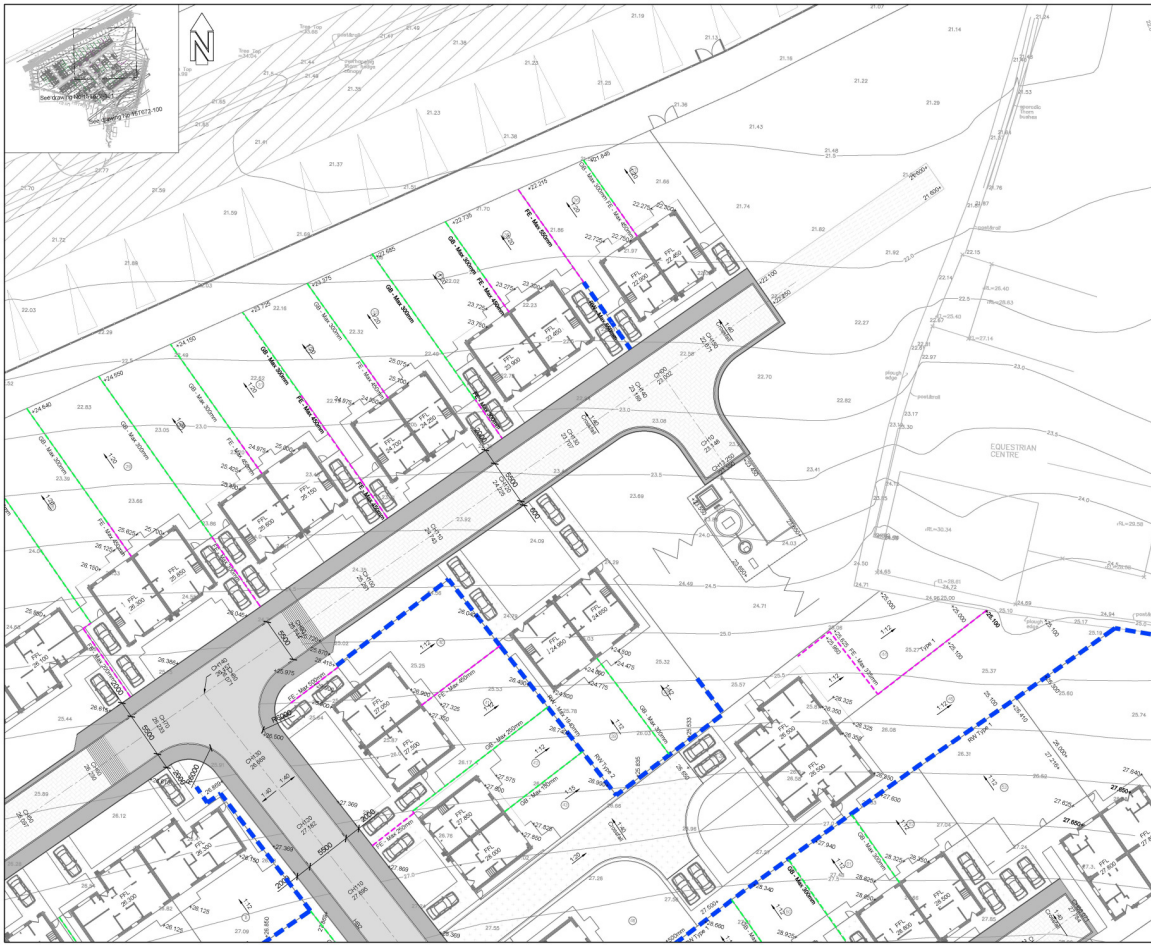

DO NOT SCALE

Notes

- All levels are in metres to Ordnance Datum (in AOD).
- The contractor is to check all dimensions and levels and report any discrepancies or omissions to the Engineer.
- All works and materials to be in accordance with:
- North Yorkshire County Council Specification for Highways
- Road and Drainage Act 1936
- The drawing is to be read in conjunction with BOP specification
- Notes and channels shall be laid true to line and level and shall not be worked until inspected and approved by the Engineer.
- All dimensions are in millimetres unless otherwise noted.
- For surface areas refer to architect's specification & details.
- For building set-out, see architect's plan.
- Existing services within areas of work are to be investigated and checked if proposed where required.
- Contractor is to arrange inspection of proposed highway during works, any inspection comments are to be reported back to Engineer and incorporated on site.

Legend

- Proposed Levels
- Existing Levels
- 150mm x 225mm Half Battered Kerb
- 50 x 150mm Flat Kerb Edging
- Centre kerb (25mm thick)
- Chop kerb
- Channel Block kerb finish
- Proposed Highway Construction
- Proposed Footpath Construction
- Proposed Block Paving
- Proposed Grasscrete
- Proposed Permeable Paving
- Proposed Retaining Wall
- Proposed Flag on Edge
- Proposed Chert Board

REVISED PLAN

This drawing has been revised to reflect the amendments of the original contract documents. It is the responsibility of the contractor to ensure that they have the latest version of the drawing and to check the drawing against the contract documents. The contractor shall not be held responsible for any errors or omissions on the drawing.

Level revised	Issue	TC	PA	SR	28.02.18
Driveway addition revised	TC	PA	SR	03.01.18	
Revised garden gradients	TC	PA	SR	03.01.18	
Issued as Information	RL	PA	SR	12.12.17	
Issue/Checked	BY	CHK	DATE		

A printed copy of this drawing is available for purchase from the Engineer. The Engineer is not responsible for the accuracy of the drawing or for any errors or omissions on the drawing. The contractor shall be responsible for ensuring that they have the latest version of the drawing and for checking the drawing against the contract documents.

Client
Lindum Group

Project
Rainbow Lane
Malton
North Yorkshire

Drawing Title
Proposed External Works Plan
Sheet 3 of 3

Drawn	RL	Date	01.12.17
Checked	SR	Date	01.12.17
Scale	1:200	Original Size	A1

billingham george & partners
CIVIL & STRUCTURAL ENGINEERS
INCORPORATED IN ENGLAND
18 Floor, Wellington House, Wellington Court,
Woodhouse Lane, 1818 3TA
Leeds LS2 9PL
www.billinghamgeorge.com

Dwg No: **151672-102** Rev: **P4**

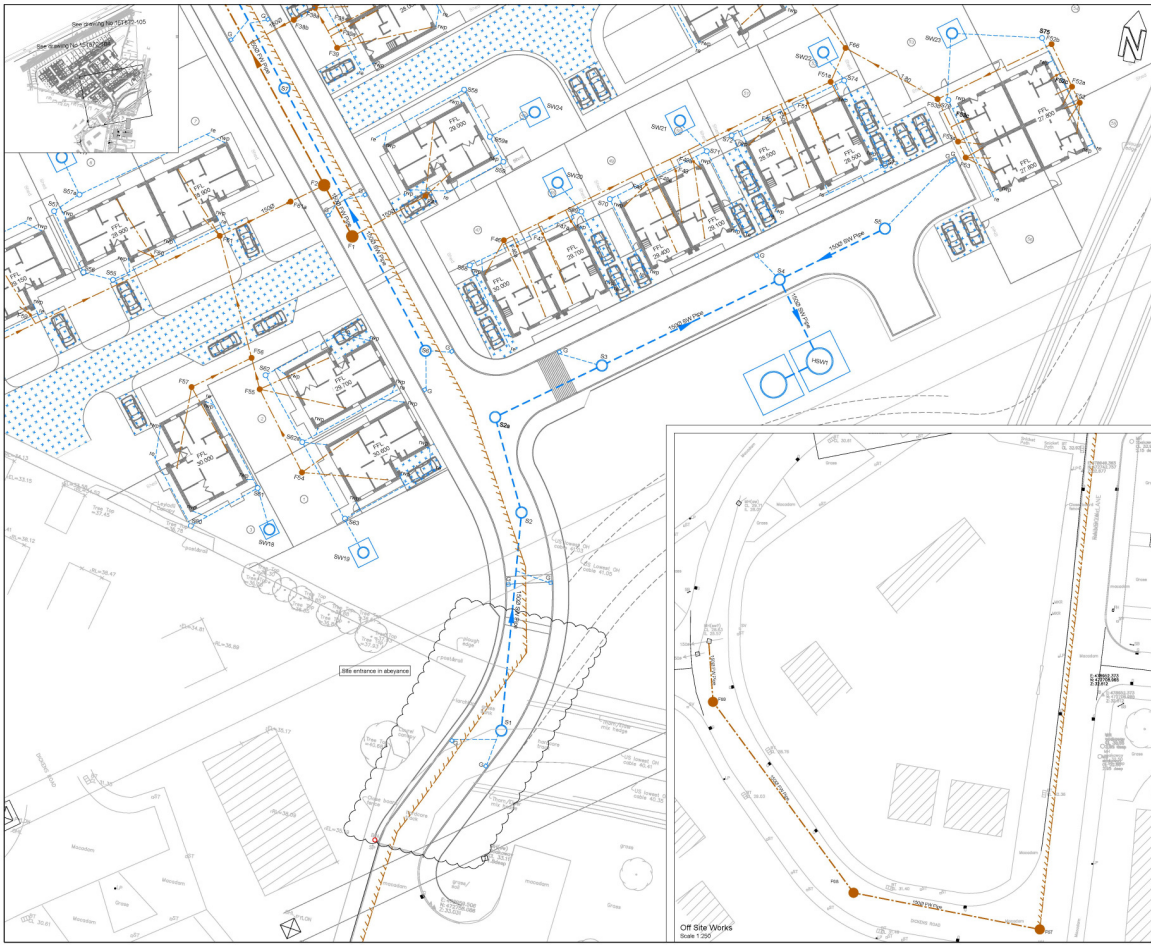

DO NOT SCALE

Notes
 All works are to be in accordance with:
 - SUDS for SUDS
 - All levels shown are in metres and are relative to site datum
 - Invert levels of all existing drains and connection points are to be confirmed and engineer advised prior to commencement of any drainage works
 - Concrete bed and surround is required to all gully leads and to all pipes in highway/standing where cover to pipe <math>< 100\text{mm}</math>
 - All pipes to be either extra strength V.C. to BS 65 or pipe to BS 6602 or BS 6441 (UPVC) or TROLEX or concrete pipe
 - Class M to BS 5911
 - All SUDS / pop-up positions must be confirmed with architect's details
 - Abandonment of Adopted Sewers will be covered under a section 105 agreement with Yorkshire Water
 - Existing private sewers within the site are to be grubbed up
 - New connection to Yorkshire Water SW under a section 105 agreement to be arranged by contractor
 - Contractor is responsible for positioning M/Lites so they do not sit beneath the surfaces
 - Pipe horizontal gullies to be 1000

Design characteristics for Soakaway design
 Mean Soil permeability > 2.75 x 10⁻⁴ m/s

- Legend**
- New FV Drain
 - New SV Drain
 - Highway Gully
 - Rain Water Pipe
 - Rain Water Pipe
 - Backing Manhole
 - Permeable Paving

All driveways to be installed with permeable paving

REVISED PLAN
 This plan has been revised in accordance with the comments of the client and the contractor. It is the responsibility of the contractor to ensure that the correct version of the plan is used on site.

Site Layout updated	TC	T3	SR	28.02.18
Site Layout updated	DR	FS	TC	31.01.18
Issue for Information	RL	F1	SR	13.12.17

NO	BY	REV	DATE
1	RL	1	13.12.17

Client
 Lindum Group

Project
 Rainbow Lane
 Malton
 North Yorkshire

Drawing Title
 Proposed Drainage Plan
 Sheet 1 of 3

Drawn	RL	Date	12.12.17
Checked	SR	Date	12.12.17
Scale	1:200	Original Size	A1

bgp Billingham George & Partners
 CIVIL & STRUCTURAL ENGINEERS
 14 Floor, Wellington House, Wellington Court,
 100 Woodhouse Lane, Leeds, LS2 1TA
 T: 0113 275 0000 F: 0113 275 0001
 E: info@billinghamgeorge.co.uk www.billinghamgeorge.co.uk

Dwg No: 151672-103 Rev: P3

DO NOT SCALE

Notes

- All works are to be in accordance with:
 - BS8000 for construction
- All levels shown are in metres and are relative to site datum
- Invert levels of all existing gullies and connection points are to be confirmed and engineer advised prior to commencement of any Drainage Works
- Concrete bed and surround is required to all gully leads and to all pipes in highways/footpaths where cover to pipe $\le 100\text{mm}$
- All BSIP (prop-up positions) shall be confirmed with architect/owner
- Abandonment of Adopted Sewers will be covered under a section 105 agreement with Yorkshire Water
- Existing private sewers within the site are to be grubbed up
- New connection to Yorkshire Water M4 under a section 105 agreement to be engaged to contractor
- Contractor is responsible for positioning M4/Lites so they do not sit beneath the surface
- All Drains are 1000 D.I.D
- Pipes horizontal gullies to be 1000

Design characteristics for Soakaway design
New Soakaway: 2.75m x 4m

Legend

- New F/W Drain
- New S/W Drain
- Highway Gully
- Rain Water Pipe
- Rain Water Pipe
- Backing Kerbside
- Permeable Paving

All driveways to be installed with permeable paving

REVISED PLAN

This plan has been revised by the works to the site of the proposed works and any changes to the original plan are shown in red. The original plan is shown in black. The revised plan is shown in red. The original plan is shown in black.

Site Layout updated	TIC	PS	SR	28.02.18
Site Layout updated	DW	PS	TC	31.01.18
Issued as Information	RL	PS	SR	13.12.17
REVISIONS	BY	REV	DATE	
New: 1. Proposals 2. Topog 3. Construction 4. Land Ownership				

Client
Lindum Group

Project
Rainbow Lane
Malton
North Yorkshire

Drawing Title
Proposed Drainage Plan
Sheet 2 of 3

Drawn	RL	Date	12.12.17
Checked	SR	Date	12.12.17
Scale	1:200	Original Size	A1

bgp Billingham George & Partners
CIVIL & STRUCTURAL ENGINEERS
REGISTERED SUPPLIER
14 Floor, Wellington House, Wellington Court,
Woodhouse Hill, 1818 7th
Leeds LS2 9PL
t: 0113 244 1111
e: info@billingham-george.co.uk

Dwg No: 151672-104 Rev P3

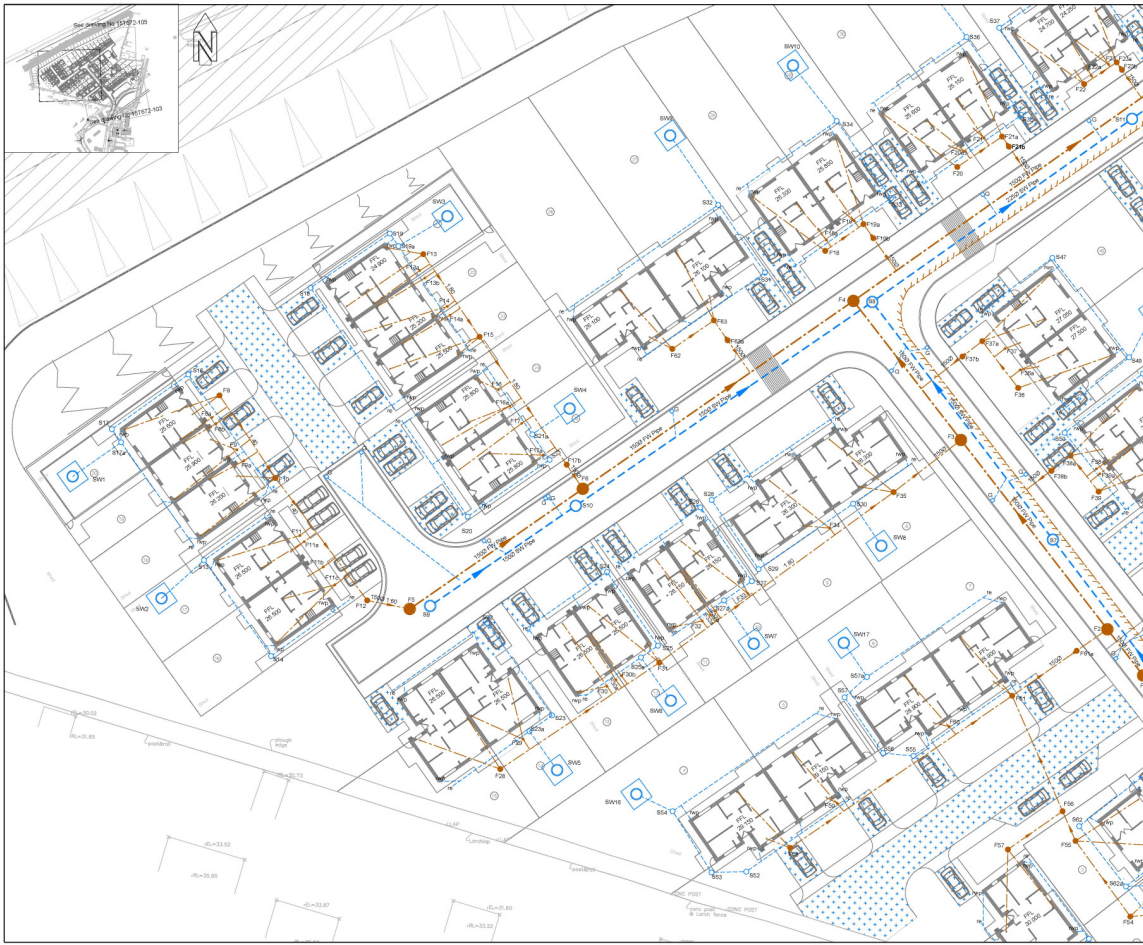

THIS COPY HAS BEEN MADE BY ME WITH THE AUTHORITY OF ORIGINAL DRAWING CONTRACTOR AND I ACCEPT FULL RESPONSIBILITY FOR THE ACCURACY OF THIS COPY. ANY CHANGES TO THIS COPY MUST BE APPROVED BY THE ORIGINAL CONTRACTOR. THE USER MUST NOT BE CONSIDERED THE FIRST FORFEITER OF THE COPYRIGHT OWNER.

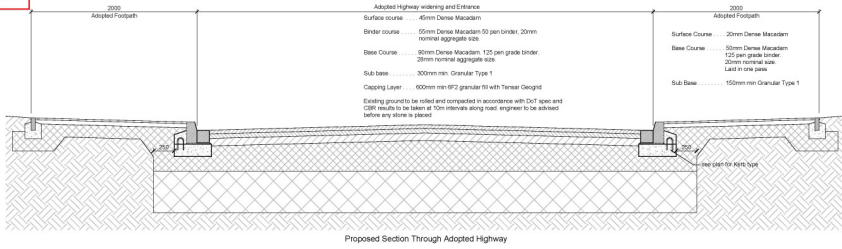

Proposed Section Through Adopted Highway

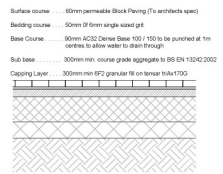

Proposed Section Through Private Block Paved Driveways

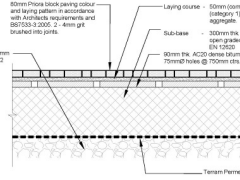

Typical Permeable Paving Private Access Roads

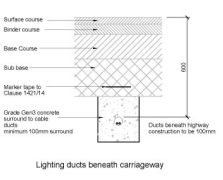

Lighting ducts beneath carriageway

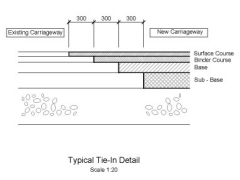

Typical Tie-In Detail

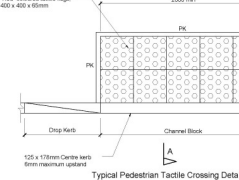

Typical Pedestrian Tactile Crossing Detail

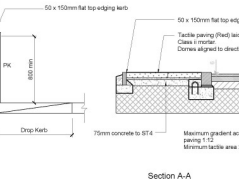

Section A-A

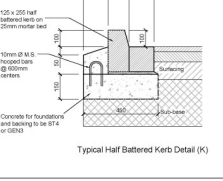

Typical Half Battered Kerb Detail (K)

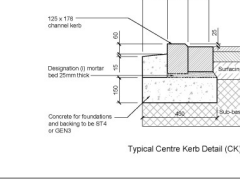

Typical Centre Kerb Detail (CK)

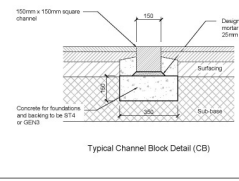

Typical Channel Block Detail (CB)

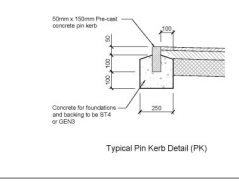

Typical Pin Kerb Detail (PK)

DO NOT SCALE

Notes
 All levels are in metres to Ordnance Datum (m AOD).
 The contractor is to check all dimensions and levels and report any discrepancies or omissions to the engineer.
 All works and materials to be in accordance with:
 i) North Yorkshire County Council Specification for Highways,
 ii) Road and Streetworks Act,
 iii) The drawing is to be read in conjunction with BCP specification.
 Kerbs and channels shall be laid true to line and level and shall not be backed until inspected and approved by the Engineer.
 All dimensions are in millimetres unless otherwise noted.
 For surfacing areas refer to architects specification & details.
 Existing areas within areas of work are to be investigated and diverted / dropped where required.

Issued for information	SR	PN	SR	DATE
11/12/17	SR	PN	SR	11/12/17
Rev P1 - Final/Ready To Tender - Construction - 40 - As Built				

Client
Mulberry Homes Yorkshire

Project
Proposed Housing Development Westgate Old Malton

Drawing Title
Proposed Highway Details

Drawn	SR	Date	11/12/17
Checked	RL	Date	11/12/17
Scale	NTS	Original Size	A1

bgp Billingham George & Partners
 CIVIL & STRUCTURAL ENGINEERS
 100-102A, SUNNING DRIVE
 WESTGATE HOUSE, TWISDALE SOUTH, THORNTHORPE
 YO26 0JH, YORK
 T: 01904 610100
 E: enquiries@bgp.co.uk
 W: www.billinghamgeorge.co.uk

Dwg No: **151672-106** Rev **P1**

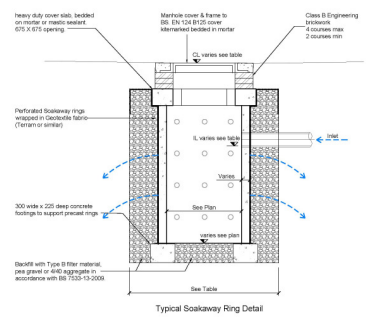

Maintenance Schedule	Required Action	Typical Frequency
Regular Maintenance	Inspect for sediment and debris in pre-treatment components and floor of inspection tube or chamber and inside of concrete manhole rings	Annually
	Cleaning of gutters and any filters on downpipes	Annually (or as required based on inspections)
Occasional Maintenance	Trimming any roots that may be causing blockages	Annually (or as required)
	Remove sediment and debris from pre-treatment components and floor of inspection tube or chamber and inside of concrete manhole rings	As required, based on inspections
Remedial Actions	Reconstruct soakaway and/or replace or clean void fill if performance deteriorates or failure occurs	As required
	Replacement of clogged geotextile (will require reconstruction of soakaway)	As required
Monitoring	Inspect silt traps and note rate of sediment accumulation	Monthly in the first year and then annually
	Check soakaway to ensure emptying is occurring	Annually

Maintenance schedule in accordance with Civil SUDS manual 753

PROPOSED SOAKAWAY DRAINAGE						
REF	COVER LEVEL*	INVERT LEVEL	INVERT LEVEL (AS-BUILT)	DEPTH	WIDTH	COMMENTS
SW1	TO FFL	24.600	25.800	1.200	2700	52.765
SW2	28.300	25.200	23.800	1.500	2700	52.765
SW3	28.300	23.700	22.300	1.400	2700	52.765
SW4	28.500	24.800	23.400	1.400	2700	52.765
SW5	28.500	26.400	25.000	1.500	2700	52.765
SW6	28.200	25.100	23.700	1.500	2700	52.765
SW7	28.600	25.000	23.600	1.500	2700	52.765
SW8	28.600	25.000	23.600	1.500	2700	52.765
SW9	28.300	24.600	23.200	1.400	2700	52.765
SW10	28.300	24.600	23.200	1.400	2700	52.765
SW11	28.300	23.800	22.400	1.400	2700	52.765
SW12	27.650	23.550	22.150	1.400	2700	52.765
SW13	27.500	22.200	20.800	1.400	2700	52.765
SW14	28.300	21.400	20.000	1.300	2700	52.765
SW15						
SW16	28.300	28.000	26.600	1.400	2700	52.765
SW17	28.500	27.600	26.200	1.300	2700	52.765
SW18	28.500	28.000	26.600	1.400	2700	52.765
SW19	28.250	28.700	27.300	1.400	2700	52.765
SW20	28.600	28.600	27.200	1.400	2700	52.765
SW21	28.950	28.600	28.600	1.300	2700	52.765
SW22	28.300	27.300	25.900	1.400	2700	52.765
SW23	28.300	26.700	25.300	1.300	2700	52.765
SW24	28.300	28.100	27.100	1.200	1800	52.765
SW25	27.650	26.650	25.250	1.400	2700	52.765
SW26	27.650	26.700	25.300	1.300	2700	52.765
SW27	27.650	24.450	23.050	1.300	2700	52.765
SW28	27.650	25.500	24.100	1.300	2700	52.765
SW29	30.500	26.200	24.800	3.000	9500	52.765
SW30	30.500	26.200	24.800	3.000	9500	52.765
SW31	22.000	20.000	18.800	3.000	9500	52.765

* Cover levels are approximate only and may vary on site

Issued as Information	RL	P1	SR	13.12.17	
APPROVED	BY	REV	CHK	DATE	
Rev 1 - 13/12/17 - 1 - Update C-Checklist to C-1 - See above					
I am a professional engineer and I am not liable for any errors or omissions in this drawing unless I have signed and dated it and it is a copy of the original.					
Client Lindum Group					
Project Rainbow Lane Malton North Yorkshire					
Drawing Title Proposed Plot Soakaway Details					
Drawn	RL	Date	13.12.17		
Checked	SR	Date	13.12.17		
Scale	1:10	Original Size	A1		
Billingham George & Partners CIVIL & STRUCTURAL ENGINEERS MALTON & SKIPTON OFFICE Waterhouse House, Tweedale South, Thorsby, Skipton, North Yorks, YO13 0AA T: 01549 831000 E: enquiries@billinghamgeorge.co.uk					
Dwg No.	151672-107			Rev	P1

THIS COPY HAS BEEN MADE BY OR WITH THE AUTHORITY OF RYedale DISTRICT COUNCIL PURSUANT TO SECTION 42 OF THE COPYRIGHT DESIGN AND PATENTS ACT 1988, UNLESS THAT ACT PROVIDES A RELEVANT EXCEPTION TO COPYRIGHT. THE COPY MUST NOT BE COPIED WITHOUT THE PRIOR PERMISSION OF THE COPYRIGHT OWNER.

*Cover levels are approximate only and may vary on site

PROPOSED SURFACE WATER DRAINAGE					
REF	COVER LEVEL*	INVERT LEVEL	TYPE	COMMENTS	COVER TYPE
B1	23.75	27.417	B		D400
B2	23.847	28.491	B		D400
B3	23.987	28.647	B		D400
B4	23.830	28.590	B		D400
B5	23.823	28.700	B		D400
B6	23.758	28.418	B		D400
B7	23.298	28.916	B		D400
B8	23.298	24.475	B		D400
B9	23.848	25.298	B		D400
B10	23.880	24.540	B		D400
B11	24.455	23.105	B		D400
B12	22.290	20.900	B		D400
B13	23.300	25.400	PPIC		B125
B14	23.300	25.200	PPIC		B125
B15	23.000	25.100	PPIC		B125
B16	23.400	24.100	PPIC		B125
B17	23.400	23.900	PPIC		B125
B18	24.700	23.700	PPIC		B125
B19	24.700	23.300	PPIC		B125
B20	23.600	24.600	PPIC		B125
B21	23.600	24.300	PPIC		B125
B22	23.300	26.400	PPIC		B125
B23	23.300	25.900	PPIC		B125
B24	23.300	25.700	PPIC		B125
B25	23.300	25.600	PPIC		B125
B26	23.000	25.000	PPIC		B125
B27	23.000	25.000	PPIC		B125
B28	23.100	25.100	PPIC		B125
B29	23.100	24.900	PPIC		B125
B30	23.100	24.800	PPIC		B125
B31	23.800	24.600	PPIC		B125
B32	23.800	24.700	PPIC		B125
B33	23.700	24.900	PPIC		B125
B34	23.700	24.700	PPIC		B125
B35	23.000	24.000	PPIC		B125
B36	23.000	23.800	PPIC		B125
B37	24.500	23.500	PPIC		B125
B38	24.500	23.400	PPIC		B125
B39	23.300	22.800	PPIC		B125
B40	23.300	22.700	PPIC		B125
B41	22.700	21.700	PPIC		B125
B42	22.300	21.400	PPIC		B125
B43	22.300	21.300	PPIC		B125
B44	24.500	23.500	PPIC		B125
B45	24.800	23.700	PPIC		B125
B46	24.500	23.300	PPIC		B125
B47	23.800	25.600	PPIC		B125
B48	27.300	26.400	PPIC		B125
B49	27.300	26.200	PPIC		B125
B50	27.700	26.700	PPIC		B125
B51	27.700	26.500	PPIC		B125
B52	26.000	26.100	PPIC		B125
B53	26.000	26.400	PPIC		B125
B54	26.000	27.800	PPIC		B125
B55	26.700	27.000	PPIC		B125
B56	26.700	27.800	PPIC		B125
B57	26.700	27.600	PPIC		B125
B58	26.800	28.000	PPIC		B125
B59	26.800	27.600	PPIC		B125
B60	26.800	26.000	PPIC		B125
B61	26.800	26.800	PPIC		B125
B62	26.500	26.700	PPIC		B125
B63	30.400	28.500	PPIC		B125

*Cover levels are approximate only and may vary on site

PROPOSED SURFACE WATER DRAINAGE					
REF	COVER LEVEL*	INVERT LEVEL	TYPE	COMMENTS	COVER TYPE
B72	26.300	25.400	PPIC		B125
B64	26.300	25.100	PPIC		B125
B66	26.300	25.400	PPIC		B125
B67	26.500	26.700	PPIC		B125
B68	26.400	26.500	PPIC		B125
B69	26.200	26.300	PPIC		B125
B70	26.800	26.000	PPIC		B125
B71	26.800	27.800	PPIC		B125
B72	26.300	27.300	PPIC		B125
B73	26.300	27.300	PPIC		B125
B74	26.300	27.100	PPIC		B125
B75	27.800	26.700	PPIC		B125
B76	27.800	26.500	PPIC		B125

*Cover levels are approximate only and may vary on site

PROPOSED SODAKAWAY DRAINAGE						
REF	COVER LEVEL*	INVERT LEVEL	BASE LEVEL	DIA Ø	COMMENTS	COVER TYPE
B61	23.700	21.700	1200			B125
B62	24.800	22.800	1200			B125
B63	23.400	21.400	1200			B125
B64	24.000	22.000	1200			B125
B65	26.100	24.100	1200			B125
B66	24.800	22.800	1200			B125
B67	24.700	22.700	1200			B125
B68	24.500	22.500	1200			B125
B69	24.600	22.600	1200			B125
B70	24.500	22.500	1200			B125
B71	23.800	21.800	1200			B125
B72	23.200	21.200	1200			B125
B73	21.900	19.900	1200			B125
B74	21.100	19.100	1200			B125
B75	23.200	23.200	1200			B125
B76	27.700	25.700	1200			B125
B77	23.500	21.500	1200			B125
B78	26.700	24.700	1200			B125
B79	26.400	24.400	1200			B125
B80	26.300	24.300	1200			B125
B81	26.500	24.500	1200			B125
B82	26.500	24.500	1200			B125
B83	26.500	24.500	1200			B125
B84	26.500	24.500	1200			B125
B85	26.500	24.500	1200			B125
B86	26.500	24.500	1200			B125
B87	26.500	24.500	1200			B125
B88	26.500	24.500	1200			B125
B89	26.500	24.500	1200			B125
B90	26.500	24.500	1200			B125
B91	26.500	24.500	1200			B125
B92	26.500	24.500	1200			B125
B93	26.500	24.500	1200			B125
B94	26.500	24.500	1200			B125
B95	26.500	24.500	1200			B125
B96	26.500	24.500	1200			B125
B97	26.500	24.500	1200			B125
B98	26.500	24.500	1200			B125
B99	26.500	24.500	1200			B125
B100	26.500	24.500	1200			B125

*Cover levels are approximate only and may vary on site

PROPOSED FLOOD WATER DRAINAGE					
REF	COVER LEVEL*	INVERT LEVEL	TYPE	COMMENTS	COVER TYPE
F1	29.300	27.900	B		D400
F2	28.700	27.300	B		D400
F3	27.200	24.200	B		D400
F4	26.500	23.200	B		D400
F5	26.470	23.800	B		D400
F6	25.800	23.500	B		D400
F7	23.800	21.300	B		D400
F8	25.600	24.600	PPIC		B125
F9	25.700	24.000	PPIC		B125
F10	26.600	24.400	PPIC		B125
F11	26.300	24.200	PPIC		B125
F12	26.300	24.000	PPIC		B125
F13	26.300	24.200	PPIC		B125
F14	25.600	24.000	PPIC		B125
F15	25.300	23.700	PPIC		B125
F16	25.600	23.500	PPIC		B125
F17	25.600	23.300	PPIC		B125
F18	26.100	25.000	PPIC		B125
F19	25.700	25.400	PPIC		B125
F20	25.400	24.900	PPIC		B125
F21	25.000	24.300	PPIC		B125
F22	24.500	24.000	PPIC		B125
F23	24.100	23.400	PPIC		B125
F24	23.700	23.200	PPIC		B125
F25	23.300	22.700	PPIC		B125
F26	22.700	21.500	PPIC		B125
F27	22.300	21.700	PPIC		B125
F28	26.300	25.800	PPIC		B125
F29	26.300	25.600	PPIC		B125
F30	26.000	25.400	PPIC		B125
F31	26.300	25.200	PPIC		B125
F32	26.000	25.000	PPIC		B125
F33	26.000	24.800	PPIC		B125
F34	26.100	24.600	PPIC		B125
F35	26.100	24.400	PPIC		B125
F36	27.300	26.800	PPIC		B125
F37	27.600	26.600	PPIC		B125
F38	27.700	27.000	PPIC		B125
F39	27.600	27.300	PPIC		B125
F40	24.600	24.300	PPIC		B125
F41	24.500	23.900	PPIC		B125
F42	24.400	23.700	PPIC		B125
F43	26.300	25.500	PPIC		B125
F44	26.300	25.300	PPIC		B125
F45	26.600	26.000	PPIC		B125
F46	26.600	26.300	PPIC		B125
F47	26.600	26.000	PPIC		B125
F48	26.200	26.700	PPIC		B125
F49	26.600	26.400	PPIC		B125
F50	26.300	27.000	PPIC		B125
F51	26.300	27.300	PPIC		B125
F52	27.600	26.900	PPIC		B125
F53	27.600	26.800	PPIC		B125
F54	30.400	29.800	PPIC		B125
F55	29.500	29.000	PPIC		B125
F56	29.000	28.700	PPIC		B125
F57	29.000	29.300	PPIC		B125
F58	29.000	28.400	PPIC		B125
F59	29.000	28.200	PPIC		B125
F60	28.600	28.000	PPIC		B125
F61	29.700	27.900	PPIC		B125
F62	24.000	23.800	PPIC		B125
F63	32.100	30.800	B		D400
F64	31.000	29.600	B		D400
F65	29.200	27.800	B		D400
F66	29.300	28.700	B		B125

Issued as Information		RL	F1	SR	12.12.17	
Checked		BY	REV	DATE		
Rev 1 - 12.12.17 - 1 - Update - 1 - 12.12.17						
I warrant that the design complies with all applicable codes, standards and regulations and that I am a duly qualified and registered professional engineer in the United Kingdom.						
Client Lindum Group						
Project Rainbow Lane Milton North Yorkshire						
Drawing Title Manhole Schedule						
Drawn	ZW	Date	12.12.17			
Checked	RL	Date	12.12.17			
Scale	NTS	Original Size	A1			
		Billingham George & Partners CIVIL & STRUCTURAL ENGINEERS BILKINGTON ROAD, BILKINGTON 14 Floor, Wellington House, Wellington Court, 10000-0000, Leeds, LS11 7TA t: +44 (0)113 266 6666 e: enquiries@bilingham-george.co.uk				
Dwg No.	151672-109				Rev	P1

THIS COPY HAS BEEN MADE BY OR WITH THE AUTHORITY OF RYedale DISTRICT COUNCIL PURSUANT TO SECTION 47 OF THE COPYRIGHT DESIGN AND PATENTS ACT 1988, UNLESS THAT ACT PROVIDES A RELEVANT EXCEPTION TO COPYRIGHT. THE COPY MUST NOT BE COPIED WITHOUT THE PRIOR PERMISSION OF THE COPYRIGHT OWNER.